

## AUX48.. - NIPPLO RIDOTTO ESAG. M/M ISO 1179-4 GAS CIL - 60°

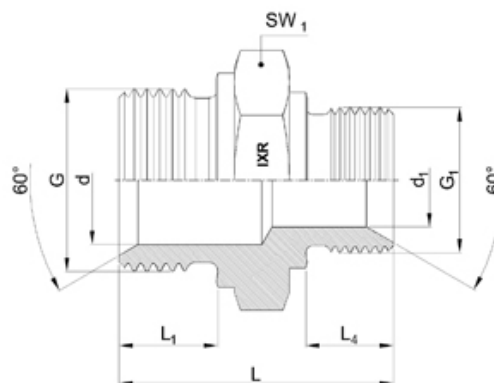

### Descrizione:

**Riferimento:** ISO 8434-6 / BS 5200

**Attacchi:** Maschio a Sede Conica e Tenuta Metallica ISO 1179-4

**Filettatura:** Gas Cilindrica UNI/ISO 228

*Vedi anche codice AUX48..*

*Vedi anche codice AUX25*

*Vedi anche codiceAUX25..Ridotto*

### Caratteristiche tecniche:

| Codice di ordinazione | G      | G1     | L    | L1 | L4 | d    | d1   | SW1 |
|-----------------------|--------|--------|------|----|----|------|------|-----|
| AUX4802               | 1/4"   | 1/8"   | 28   | 12 | 8  | 6    | 4.5  | 19  |
| AUX4804               | 3/8"   | 1/4"   | 33   | 12 | 10 | 9    | 6    | 22  |
| AUX4806               | 1/2"   | 3/8"   | 40   | 14 | 12 | 13   | 9    | 27  |
| AUX4808               | 3/4"   | 1/2"   | 45   | 16 | 14 | 18   | 13   | 32  |
| AUX4810               | 1"     | 3/4"   | 53   | 18 | 16 | 23.5 | 17   | 41  |
| AUX4812               | 1.1/4" | 1"     | 58   | 20 | 18 | 30.5 | 23   | 50  |
| AUX4814               | 1.1/2" | 1.1/4" | 61   | 22 | 20 | 37   | 30   | 55  |
| AUX4816               | 2"     | 1.1/2" | 64   | 25 | 22 | 45   | 37   | 70  |
| AUX4818               | 1/2"   | 1/4"   | 38   | 14 | 11 | 12.5 | 7    | 27  |
| AUX4819               | 1"     | 1/2"   | 48   | 18 | 14 | 23.5 | 13   | 41  |
| AUX4820               | 3/4"   | 3/4"   | 41   | 16 | 12 | 18   | 9    | 32  |
| AUX4821               | 1.1/4" | 3/4"   | 53.5 | 20 | 16 | 30.5 | 18   | 50  |
| AUX4822               | 2"     | 1"     | 62   | 25 | 18 | 43   | 23.5 | 70  |
| AUX4823               | 1"     | 3/8"   | 47   | 18 | 12 | 23   | 9    | 41  |
| AUX4824               | 3/8"   | 1/8"   | 30.5 | 12 | 8  | 9    | 4.5  | 22  |
| AUX4830               | 1.1/2" | 3/4"   | 55   | 22 | 16 | 37   | 17   | 55  |
| AUX4831               | 1.1/2" | 1"     | 57   | 22 | 18 | 37   | 23.5 | 55  |
| AUX4832               | 2"     | 1.1/4" | 62   | 25 | 20 | 45   | 30   | 70  |
| AUX4833               | 3/4"   | 1/4"   | 39.5 | 16 | 10 | 18   | 6    | 32  |
| AUX4834               | 1.1/4" | 1/2"   | 51   | 20 | 14 | 30   | 13   | 50  |