

AUX22..WD - RIDUZIONE ESAG. M/F GAS CIL - WD

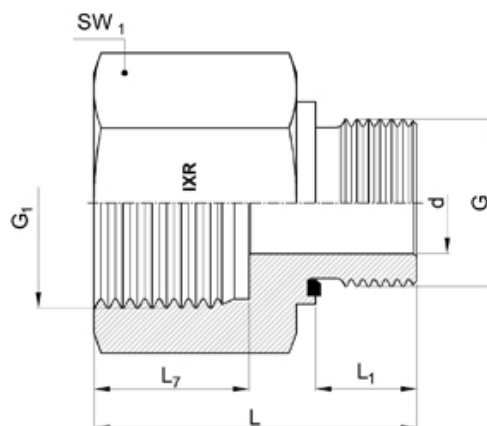

Descrizione:

Attacco Maschio: Tenuta Con Guarnizione ISO 1179-2

Guarnizione: FKM

Filettatura: Gas Cilindrica UNI/ISO 228

Adattatore tipo B

Vedi anche codice AUX21..WD

Caratteristiche tecniche:

Codice di ordinazione	G	G1	L	L1	L7	d	SW1	Forma
AUX2201-WD	1/8"	1/4"	31	8	17	4	19	B
AUX2202-WD	1/8"	3/8"	32	8	17	4	24	B
AUX2203-WD	1/4"	1/8"	28	12	12	7	19	B
AUX2204-WD	1/4"	3/8"	36	12	17	7	24	B
AUX2205-WD	1/4"	1/2"	40	12	20	5	27	B
AUX2206-WD	1/4"	3/4"	43	12	22	6	36	B
AUX2207-WD	3/8"	1/4"	36	12	17	8	22	B
AUX2208-WD	3/8"	1/2"	41	12	20	8	27	B
AUX2209-WD	3/8"	3/4"	44	12	22	8	36	B
AUX2210-WD	1/2"	3/8"	36	14	17	12	27	B
AUX2211-WD	1/2"	3/4"	46	14	22	12	36	B
AUX2212-WD	1/2"	1"	49	14	24.5	12	41	B
AUX2213-WD	1/2"	1.1/4"	53	14	26.5	12	55	B
AUX2214-WD	3/4"	1/2"	41	16	20	16	32	B
AUX2215-WD	3/4"	1"	51	16	24.5	16	41	B
AUX2216-WD	3/4"	1.1/4"	55	16	26.5	16	55	B
AUX2217-WD	3/4"	1.1/2"	57	16	28.5	16	60	B
AUX2218-WD	1"	3/4"	47	18	22	20	41	B
AUX2219-WD	1"	1.1/4"	57	18	26.5	20	55	B
AUX2220-WD	1"	1.1/2"	59	18	28.5	20	60	B
AUX2221-WD	1.1/4"	1"	52	20	24.5	25	50	B
AUX2222-WD	1.1/4"	1.1/2"	60	20	28.5	25	60	B
AUX2223-WD	1.1/2"	1.1/4"	58	22	26.5	32	55	B
AUX2224-WD	3/8"	1"	46.5	12	24.5	8	41	B
AUX2225-WD	2.1/2"	1.1/2"						B
AUX2226-WD	2"	1.1/2"						B
AUX2227-WD	1/4"	1"	46	12	24.5	6	41	B