

## AUX58.. - RACCORDO DIRITTO M/F-GIR NPT X GAS CIL - 60°

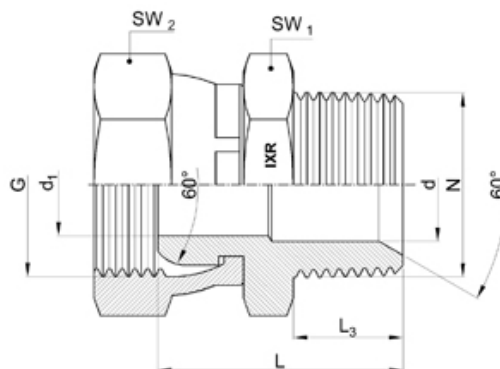

### Descrizione:

**Riferimento:** ISO 8434-6 / BS 5200

**Attacchi:** Maschio/Femmina Girevole  
Sede Conica

**Filettatura 1:** NPT -ASME

B.1.20.2M-206

**Filettatura 2:** Gas Cilindrica UNI/ISO  
228

### Caratteristiche tecniche:

Codice di ordinazione	N	G	L	L3	d	d1	SW1	SW2
AUX58-1818	1/8"	1/8"	25	10	4	4	12	14
AUX58-1414	1/4"	1/4"	32	15	7	5	14	19
AUX58-3814	3/8"	1/4"	32	15.3	10.3	5	19	19
AUX58-1438	1/4"	3/8"	33.6	15	7	7	17	22
AUX58-3838	3/8"	3/8"	33	15.3	10	8	19	22
AUX58-1238	1/2"	3/8"	40.8	20	13.5	8	22	22
AUX58-3812	3/8"	1/2"	34.8	15.3	10.3	9.5	19	27
AUX58-1212	1/2"	1/2"	42	20	13.5	9.5	22	27
AUX58-3412	3/4"	1/2"	41	20	16.5	9.5	27	27
AUX58-1234	1/2"	3/4"	43	20	13.5	16.5	27	32
AUX58-3434	3/4"	3/4"	43	20	16.5	16.5	27	32
AUX58-1134	1"	3/4"	48.5	25	24	16.5	36	32
AUX58-1111	1"	1"	49.5	25	24	21	36	41
AUX58-5454	1.1/4"	1.1/4"	53	25.5	28	28	46	50
AUX58-3232	1.1/2"	1.1/2"	57	26	32.5	32.5	50	55
AUX58-4242	2"	2"	69	26	42	42	65	70