

AUX37.. - RACCORDO A TEE F/F/F GAS CIL

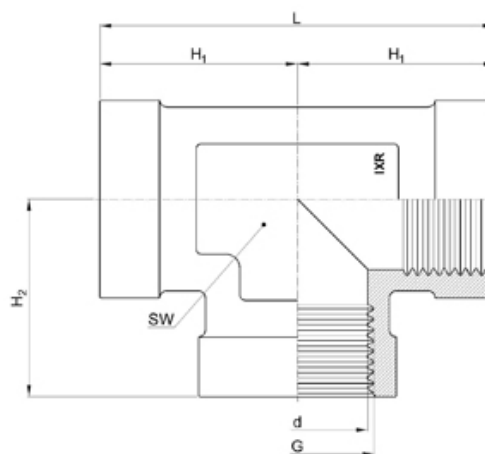

Descrizione:

Filettatura : Gas Cilindrica UNI/ISO 228

Caratteristiche tecniche:

Codice di ordinazione	G	L	H1	H2	d	SW
AUX3701	1/8"	40	20	20	8.6	17
AUX3703	1/4"	45	22.5	22.5	11.8	19
AUX3705	3/8"	52.4	26.2	26.2	15.2	24
AUX3707	1/2"	63	31.5	31.5	19	27
AUX3709	3/4"	67	33.5	33.5	24.6	36
AUX3711	1"	86	43	43	30.7	41
AUX3713	1.1/4"	102	51	51	39.3	50
AUX3715	1.1/2"					